

IP65 CONNECTOR
(CODE 'J')

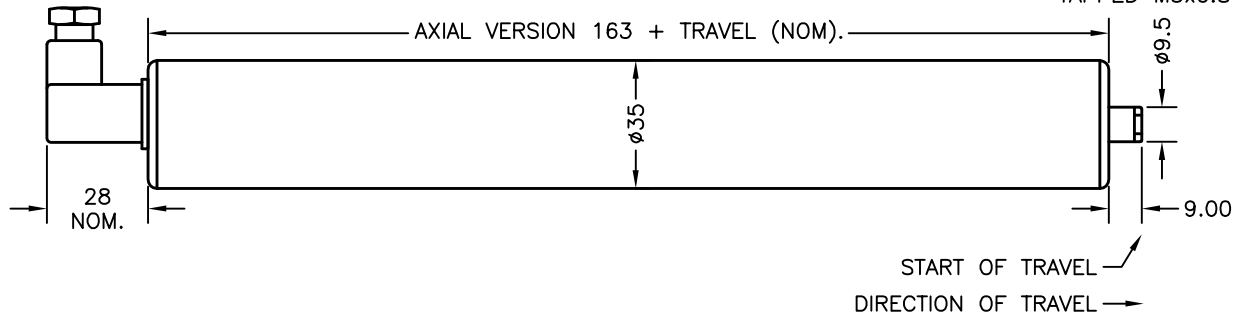

CODES	
A	
C	
D	
E	
F	
H	

ELECTRICAL OPTIONS/ SPECIFICATIONS

SUPPLY	OUTPUT
5V ±1V	0.5 TO 4.5V RATIO METRIC
13 TO 28V	0.5 TO 9.5V
±15V NOM. (±13-28V)	±10V
SUPPLY CURRENT 20mA MAX.	
18 TO 28V	4 TO 20mA 2-WIRE
13 TO 28V	4 TO 20mA 3-WIRE SINK
13 TO 28V	4 TO 20mA 3-WIRE SOURCE
SINK VERSION OUTPUT COMPLIANCE 5-28V	
SOURCE VERSION DRIVE 300Ω MAX TO 0V	

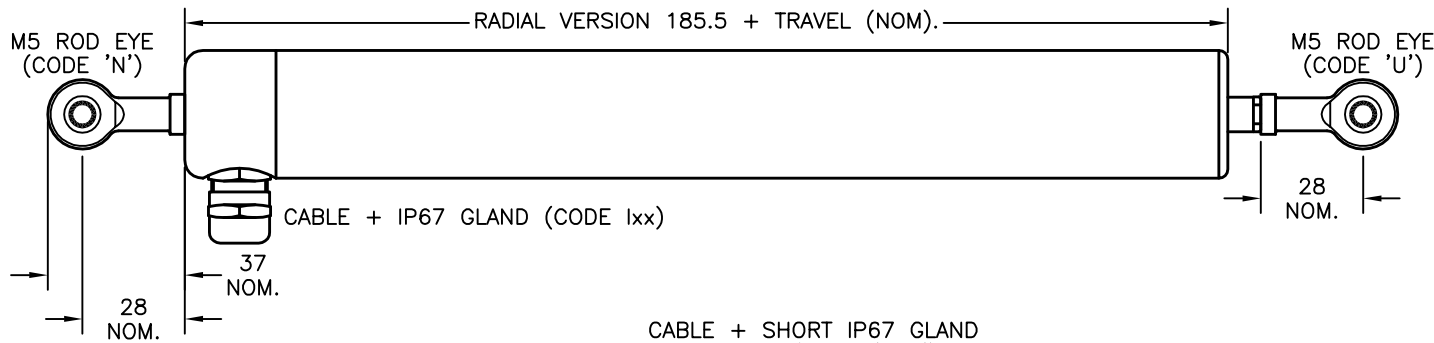

CABLE LENGTH ORDERED IN cm.
 3-CORE SCREENED: 0.2mm², ø4mm PUR JACKET
 4-CORE SCREENED: 0.2mm², ø4.6mm PUR JACKET

CABLE/CONNECTOR CONNECTIONS;

3 CORE	4 CORE	CONNECTOR	
RED	RED	1	+Ve
BLACK	GREEN	3	0V
	YELLOW		-Ve
WHITE	BLUE	2	OUTPUT
SCREEN	SCREEN	4	BODY

BODY MATERIAL:- STAINLESS STEEL.

FURTHER OPTIONS:

- BODY CLAMP/S CODE 'P'/'P2')
- SPRING RETURN TARGET, TRAVEL <250mm
- RETURN TO EXTENDED POSITION (CODE R)
- RETURN TO RETRACTED POSITION (CODE S)
- FREE TARGET (CODE 'V')

CABLE + SHORT IP67 GLAND
- AXIAL (CODE 'Mxx')

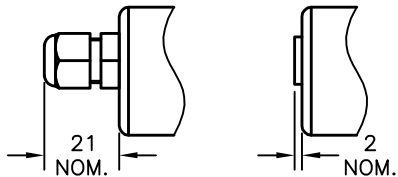

CABLE + IP67 GLAND
- AXIAL (CODE 'Lxx')

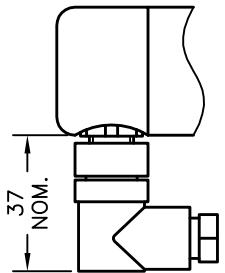

IP67 M12 CONNECTOR
- RADIAL (CODE 'K')

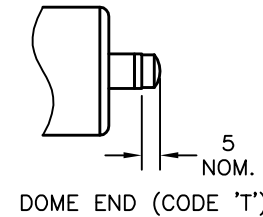

I	RADIAL VERSION LENGTH CORRECTED,	
	OPTIONS ADDED.	PDM
J	OPTION S ADDED	RDS

THE TARGET RETRACTS A FURTHER 3mm NOM. FROM SPECIFIED TRAVEL.
 STANDARD TARGETS EXTEND A FURTHER 8mm NOM. FROM SPECIFIED TRAVEL, 'V' CODED TARGETS WILL DEPART SENSOR BODY.

DRAWINGS NOT TO BE CHANGED WITHOUT REFERENCE TO THE CHANGE PROCEDURE.
 CHANGES TO PARTS USED IN INTRINSICALLY SAFE PRODUCT MUST BE APPROVED BY THE AUTHORISED PERSON
 THIS IS AN UNCONTROLLED PRINT AND WILL NOT BE UPDATED.

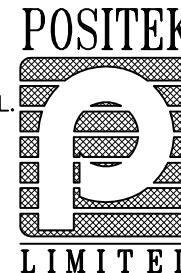

I	22/11/05		CHECKED BY	X	±0.4
J	10/5/06		PDM	X.X	±0.2
				X.XX	±0.1
					DIMS mm
DESCRIPTION					
STAND ALONE LINEAR SENSOR (TRAVEL: 50-600mm)					
SCALE 20mm			DRAWING NUMBER P101-11		
			REV J		
SHEET 1 OF 1					