

IP65 CONNECTOR  
(CODE 'J')

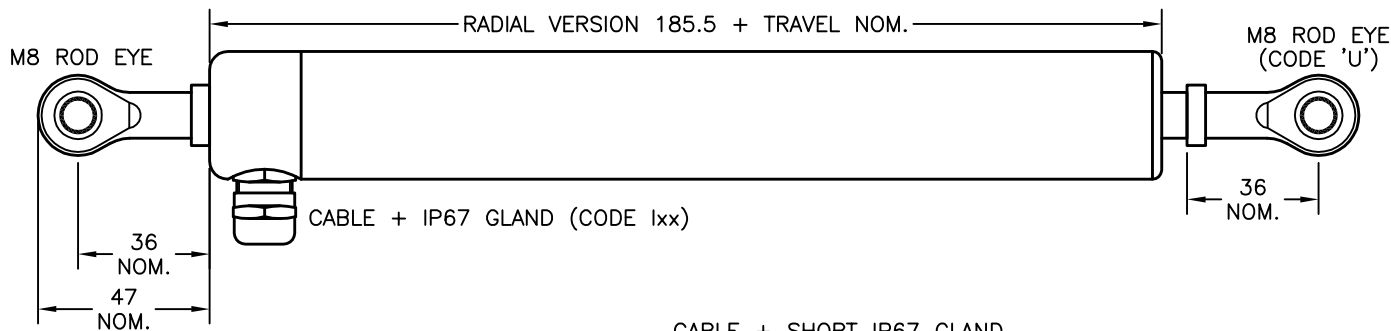

CABLE + SHORT IP67 GLAND  
- AXIAL (CODE 'Mxx')

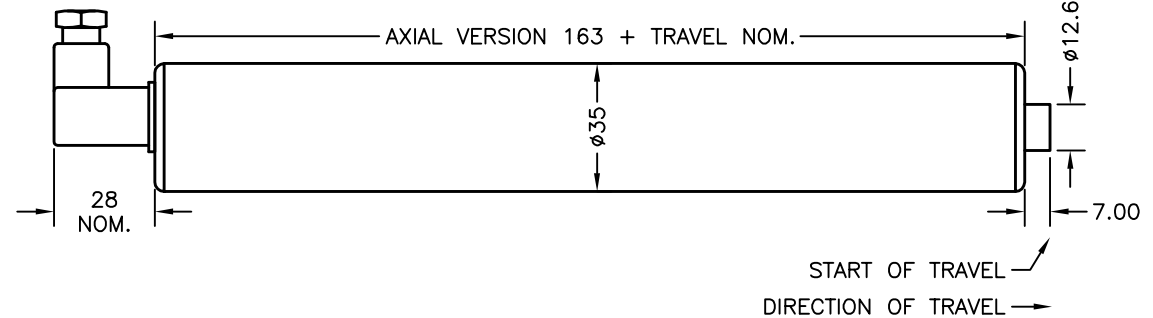
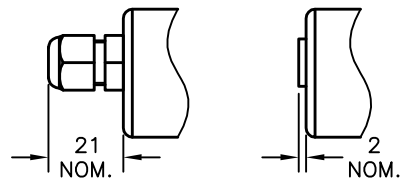

CABLE + IP67 GLAND  
- AXIAL (CODE 'Lxx')

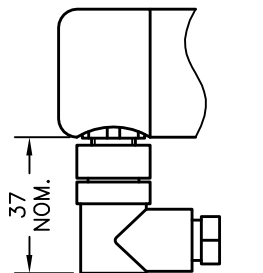

IP67 M12 CONNECTOR  
- RADIAL (CODE 'K')

CODES  
A  
C  
D  
E  
F  
H

ELECTRICAL OPTIONS/ SPECIFICATIONS

	SUPPLY	OUTPUT
A	5V ±1V	0.5 TO 4.5V RATIO METRIC
C	13 TO 28V	0.5 TO 9.5V
D	±15V NOM. (±13-28V)	±10V
SUPPLY CURRENT 20mA MAX.		
E	18 TO 28V	4 TO 20mA 2-WIRE
F	13 TO 28V	4 TO 20mA 3-WIRE SINK
H	13 TO 28V	4 TO 20mA 3-WIRE SOURCE
SINK VERSION OUTPUT COMPLIANCE 5-28V		
SOURCE VERSION DRIVE 300Ω MAX TO 0V		

CABLE LENGTH ORDERED IN cm.  
3-CORE SCREENED: 0.2mm<sup>2</sup>, ø4mm PUR JACKET  
4-CORE SCREENED: 0.2mm<sup>2</sup>, ø4.6mm PUR JACKET

CABLE/CONNECTOR CONNECTIONS;

3 CORE	4 CORE	CONNECTOR	
RED	RED	1	+Ve
BLACK	GREEN	3	0V
	YELLOW		-Ve
WHITE	BLUE	2	OUTPUT
SCREEN	SCREEN	4	BODY

BODY MATERIAL:- STAINLESS STEEL.

FURTHER OPTIONS:  
BODY CLAMP/S CODE 'P'/'P2')  
SPRING RETURN TARGET, TRAVEL <250mm  
RETURN TO EXTENDED POSITION (CODE R)  
RETURN TO RETRACTED POSITION (CODE S)  
FREE TARGET (CODE 'V')

A	FIRST ISSUE	
B	RADIAL VERSION LENGTH CORRECTED, OPTIONS ADDED.	PDM
C	S & R OPTIONS ADDED.	PDM

THE TARGET RETRACTS A FURTHER 3mm NOM. FROM SPECIFIED TRAVEL.  
STANDARD TARGETS EXTEND A FURTHER 8mm NOM. FROM SPECIFIED TRAVEL, 'V' CODED TARGETS WILL DEPART SENSOR BODY.

DRAWINGS NOT TO BE CHANGED WITHOUT REFERENCE TO THE CHANGE PROCEDURE.  
CHANGES TO PARTS USED IN INTRINSICALLY SAFE PRODUCT MUST BE APPROVED BY THE AUTHORISED PERSON  
THIS IS AN UNCONTROLLED PRINT AND WILL NOT BE UPDATED.

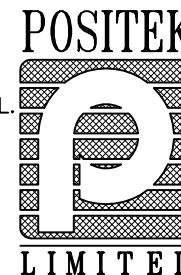

A	07/10/03		CHECKED BY	X	±0.4
B	22/11/05		PDM	X.X	±0.2
C	10/5/06			X.XX	±0.1
					DIMS mm
DESCRIPTION					
RUGGED LINEAR SENSOR (TRAVEL: 50-600mm)					
SCALE 20mm ↔			DRAWING NUMBER P111-11 REV C		
SHEET 1 OF 1					