

CHECKED AT REV. **G**

RDS

- NOTES:-
1. BODY MATL: AL ALLOY .
  2. SHAFT SHOWN IN MID-OUTPUT POSN.

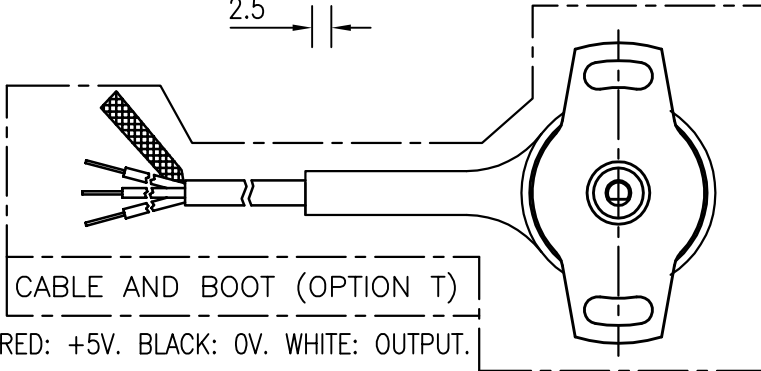
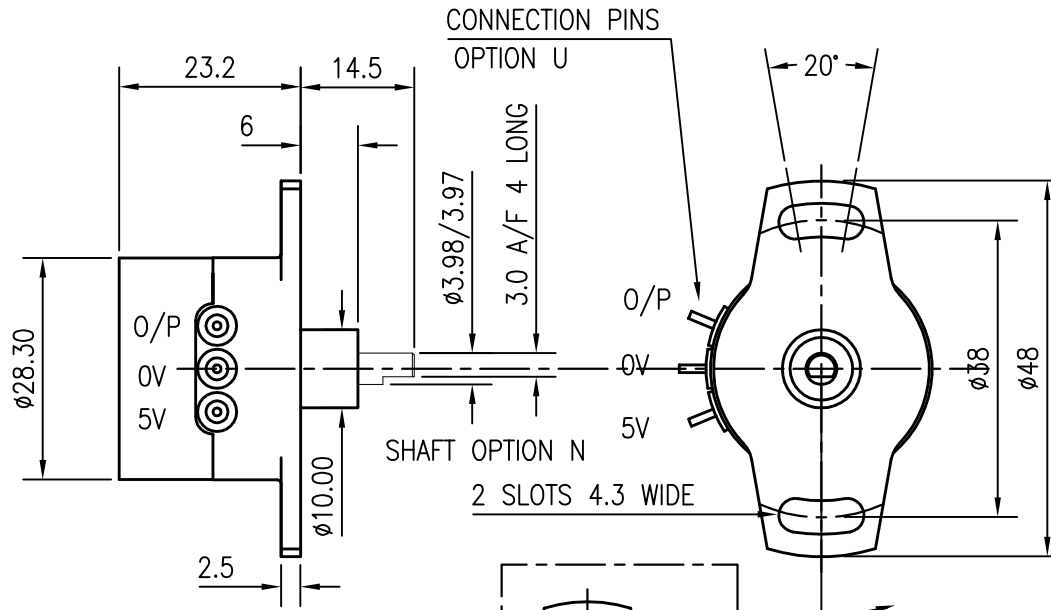

CONNECTIONS: RED: +5V. BLACK: 0V. WHITE: OUTPUT.

INCREASING VOLTAGE  
CALIBRATED SECTOR  
MID TRAVEL  
OUTPUT  $\pm 5^\circ$

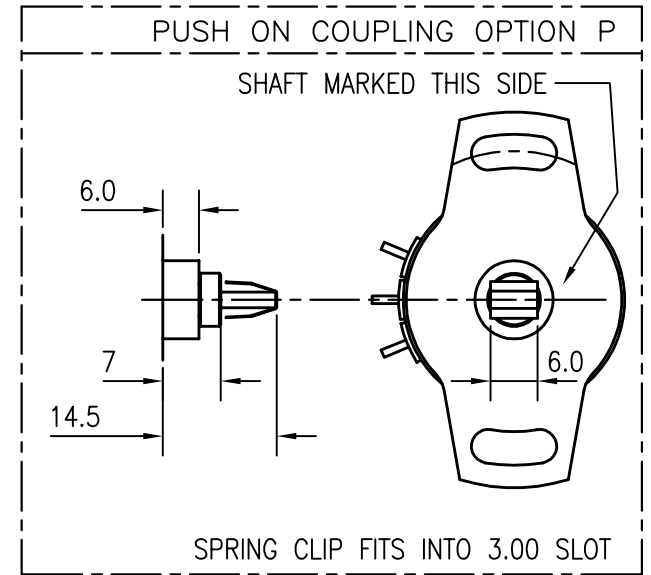

POSITION	0%	100%
OUTPUT	0.5V	4.5V
CALIBRATION	$\pm 0.018V$	$\pm 0.018V$

FACTORY CALIBRATED FOR RANGES OF  $30^\circ$  TO  $140^\circ$

A	FIRST ISSUE	NRW
B	CABLE & CLAMP ALTERED	NRW
C	CALIBRATION ANGLES ADDED FLAT WAS 2	RDS
D	BOSS LEN 6 WAS 7.3. HT 29 WAS 30	NRW
E	CLAMP LID DROPPED	RDS
F	CLIBRATION RANGES ADDED	RDS
G	SHAFT MARK ADDED	RDS

DRAWING NOT TO BE CHANGED WITHOUT REFERENCE TO THE CHANGE PROCEEDURE.  
CHANGES TO PARTS USED IN INTRINSICALLY SAFE PRODUCT MUST BE APPROVED  
BY THE AUTHORISED PERSON  
THIS IS AN UNCONTROLLED PRINT AND WILL NOT BE UPDATED

**POSITEK**  
**LIMITED**

A	22/11/96		MATERIAL	X $\pm 0.4$
B	27/01/97		SEE NOTE 1	X.X $\pm 0.2$
B	24/3/97			X.XX $\pm 0.1$
DESCRIPTION				ALL DIMS mm
D	04/12/97	ROTARY POSITION SENSOR		
E	16/3/99			
F	28/09/00			
G	19/8/02			
SCALE		DRAWING NUMBER		P501-11 REV <b>G</b>
10mm				
		SHEET		1 OF 1